

Alpine

1,928 sq. ft.
3 BR / 2-1/2 BA

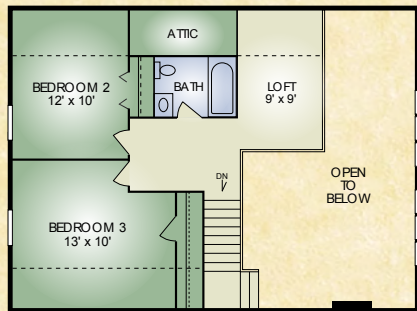

SECOND FLOOR

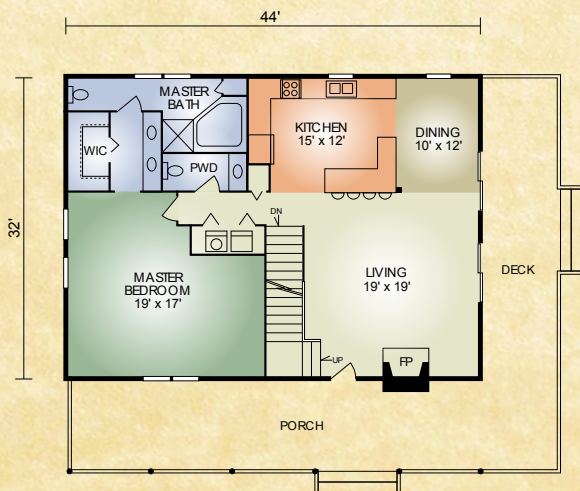

FIRST FLOOR

The Alpine is a picturesque 3-bedroom home with its inviting porch and features galore inside. The popular open-concept great room has an impressive large stone fireplace, visible from the inside and out, and a fully timbered cathedral ceiling. The master bedroom has its own private walk-in closet and master bath large enough for the hot tub you've always wanted and a double sink. Upstairs, there are two bedrooms and a bath. The loft is perfect for an entertainment center or office and offers a dramatic view of the dining area and great room below. The Alpine offers lots of living in a practical and economical design.

A full set of blueprints of this plan is available. Photo and floor plans may differ slightly from actual blueprints.



HOCHSTETLER
LOG HOMES DONE RIGHT

552 St. Rt. 95, Loudonville, Ohio
800.368.1015